



**MANUFACTURER**

Muraflo  
844-MUR-AFLO (687-2356)  
<https://www.muraflo.com>

**DESCRIPTION**

Fully finished, prefabricated shower tray that combines a structural base, with tile, mosaic, grout, and integrated drain.

**COLORS & FINISHES (see page 2)**

Soft Stone Collection is available in 2 colors. Each color combines ceramic square mosaic with porcelain curb tile, rounded curb trim, and grout.

**STRUCTURAL BASE**

Lightweight, one-piece, composite core. Waterproof and sealed on all surfaces. Integral 1¼” flange that extends over the curb. Drain bonded into tray.

**PACKAGING**

Cardboard box with internal floating system comprised of foam inserts.

**WEIGHT**

**(BASE WITH FINISH MATERIALS)**  
40 - 65 lbs.  
(Weight is nominal and varies per tray size.)

**STANDARD SIZES WITH DRAIN PLACEMENT**

		Width (W) in			
		36	42	48	60
Depth (D) in	30				X = 30 Y = 14
	32			X = 24 Y = 15	X = 30 Y = 15
	34			X = 24 Y = 16	X = 30 Y = 16
	36	X = 18 Y = 17		X = 24 Y = 17	X = 30 Y = 17
	42		X = 21 Y = 20		

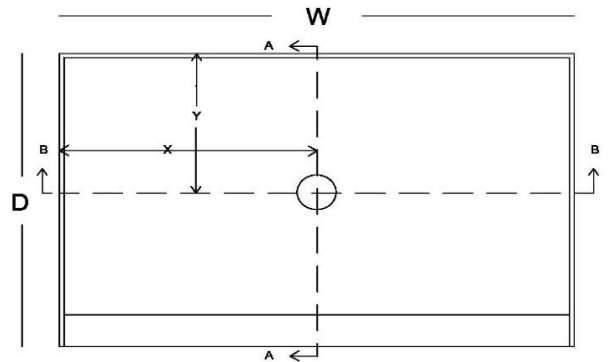

Tolerances: W = +/-1/8"; D = + curb tile thickness; X = +/-1/8"; Y = +/-1/8"

**CROSS SECTION**

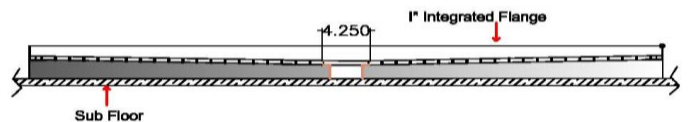
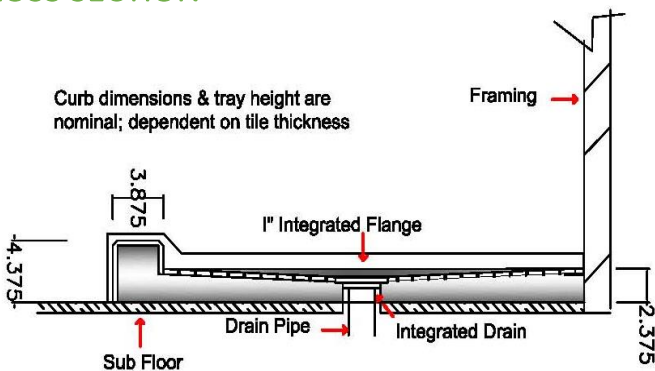

Drain fitting protrudes a nominal ½” beneath the underside of the tray. The protrusion has a nominal radius of 3½”.  
Tile and mosaic placement has a +/-3/32” tolerance in all directions.



MURAFLO

PRODUCT: SHOWER TRAY w/CURB – ALL SIZES  
COLLECTION: SOFT STONE – ALL COLORS

SOFT STONE COLLECTION – ALL COLORS



Warm Notes



Cool Tones



CODES & STANDARDS

Muraflo shower trays comply with the following codes:

- 2009 – 2021 International Residential Code (IRC)
- 2009 – 2021 International Plumbing Code (IPC)
- 2009 – 2021 Uniform Plumbing Code (IPC)
- 2016 – 2018 California Plumbing Code (CPC)
- 2017 – 2020 City of Los Angeles Plumbing Code

Muraflo shower trays are certified to the following standard:

- IAPMO PS 106-2015e1,  
Tileable Shower Receptors & Shower Kits

Tested by RADCO Listing & Testing Division

FINISH MATERIAL DATA

\* Finish materials are provided by third-party suppliers

Finish	Material	Standards / Codes
Mosaic*	2" x 2" square glazed ceramic mosaic (2 colors)	Meets ANSI A137.1:2022 Standard Specifications for Ceramic Tile. In accordance with ASTM C648, ASTM C373. Meets DCOF.
Curb Tile*	Glazed porcelain (2 colors)	Meets ANSI A137.1:2022 Standard Specifications for Ceramic Tile. In accordance with ASTM C648, ASTM C373.
Curb Profile*	Anodized aluminum round edge trim (1 color)	N/A.
Grout*	High performance, polymer modified (2 colors)	Exceeds ANSI A118.7 Specifications for Ceramic Tile Grouts, Polymer-modified Cement Grout. Meets the listed ANSI A118.3 Specifications for Epoxy Grouts. ISO 13007: Classification CG2WAF.
Drain*	No-caulk, top-connect, shower module drain, with square stainless steel strainer	Complies with: Uniform Plumbing Code (UPC); International Plumbing Code (IPC); National Plumbing Code (Canada). Certified to standards: ASME A112.18.2-2020/CSA B125.2-20.

DISCLAIMERS:

Ceramic tile and mosaic, including porcelain, has variations according to dye lot & caliber.

Grout has variations in color.

Finishes on products will vary from samples and display models.

INSTALLATION

As per owner manual and installation films:

<https://www.muraflo.com/installation-films>

CARE AND MAINTENANCE

As per owner manual.

INSTALLATION / USER RISKS

As per owner manual.

LIMITED WARRANTY

Three-year limited warranty, as per owner manual.